

3.90 Socket

Product information

Material

- PVC-U = Unplasticised Polyvinylchloride

Manufacture

- Injection moulded

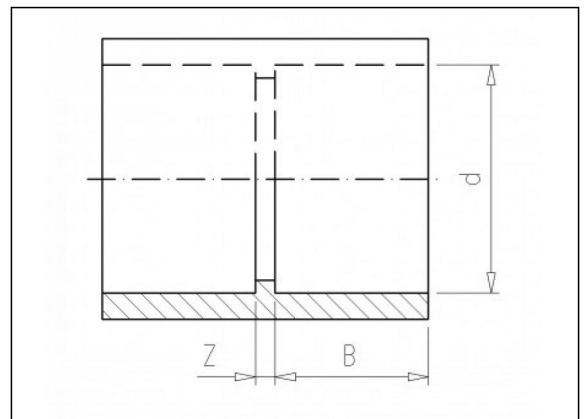

Available items

| ART.CODE | d | Z | B | PN | Verp |
|-----------|----|---|----|----|--------------------|
| 3.90.010 | 10 | 4 | 12 | 16 | 300 (6 x 50) |
| 3.90.012* | 12 | 4 | 12 | 16 | 300 (6 x 50) |
| 3.90.016* | 16 | 4 | 14 | 16 | 300 (6 x 50) |
| 3.90.020* | 20 | 3 | 16 | 16 | 300 (6 x 50) |

Van de Lande BV

Lissenveld 1 \ 4941 VK Raamsdonksveer \ The Netherlands \ t +31 (0)162 51 60 00 \ f +31 (0)162 52 14 17 \ sales@vandelande.com
Traderegister Tilburg: 18070844 \ IBAN: NL13 RABO 0143 0035 26 \ BIC: RABONL2U \ VAT: NL 8123.91.755.B01

| ART.CODE | d | Z | B | PN | Verp |
|-----------------|----------|----------|----------|-----------|-------------|
| 3.90.025* | 25 | 3 | 19 | 16 | 200 |
| 3.90.032* | 32 | 4 | 22 | 16 | 300 |
| 3.90.040* | 40 | 5 | 26 | 16 | 200 |
| 3.90.050* | 50 | 5 | 31 | 16 | 200 |
| 3.90.063* | 63 | 4 | 38 | 16 | 100 |
| 3.90.075 | 75 | 4 | 44 | 16 | 65 |
| 3.90.090 | 90 | 5 | 51 | 16 | 36 |
| 3.90.110 | 110 | 9 | 61 | 16 | 15 |
| 3.90.125 | 125 | 8 | 69 | 16 | 12 |
| 3.90.140 | 140 | 8 | 76 | 16 | 10 |
| 3.90.160 | 160 | 7 | 87 | 16 | 6 |
| 3.90.200 | 200 | 14 | 109 | 10 | 3 |
| 3.90.225 | 225 | 17 | 121 | 10 | 1 |
| 3.90.250 | 250 | 17 | 133 | 10 | 1 |
| 3.90.280 | 280 | 17 | 149 | 10 | 1 |
| 3.90.315 | 315 | 17 | 166 | 10 | 1 |

Van de Lande BV

Lissenveld 1 \ 4941 VK Raamsdonksveer \ The Netherlands \ t +31 (0)162 51 60 00 \ f +31 (0)162 52 14 17 \ sales@vandelande.com
Traderegister Tilburg: 18070844 \ IBAN: NL13 RABO 0143 0035 26 \ BIC: RABONL2U \ VAT: NL 8123.91.755.B01

All our transactions are subject to the Van de Lande General Terms of Sale. A copy of these can be provided immediately upon your request.