



PVC pressure fittings

Reinforced F/T plain 90° tee ITEM 436

Ref.	Description	Net Weight	Vol. (m ³)	Gross Weight	Units Box
1002180	PVC 90° TEE PLAIN/REINF F.THR./PLAIN 20-1/2"	0.034	0.00892	3.54	100
1002181	PVC 90° TEE PLAIN/REINF F.THR./PLAIN 25-3/4"	0.051	0.01553	5.41	100
1002182	PVC 90° TEE PLAIN/REINF F.THR./PLAIN 32-1"	0.090	0.02244	6.82	70
1002183	PVC 90° TEE PLAIN/REINF F.THR./PLAIN 40-1 1/4"	0.165	0.03682	13.82	80
1002184	PVC 90° TEE PLAIN/REINF F.THR./PLAIN 50-1 1/2"	0.218	0.04717	14.93	65
1002185	PVC 90° TEE PLAIN/REINF F.THR./PLAIN 63-2"	0.369	0.06347	14.85	38
1002186	PVC 90° TEE PLAIN/REINF F.THR./PLAIN 75-2 1/2"	0.575	0.04717	12.12	20
1002187	PVC 90° TEE PLAIN/REINF F.THR./PLAIN 90-3"	1.055	0.04717	13.30	12
1002188	PVC 90° TEE PLAIN/REINF F.THR./PLAIN 110-4"	1.685	0.06149	17.77	10



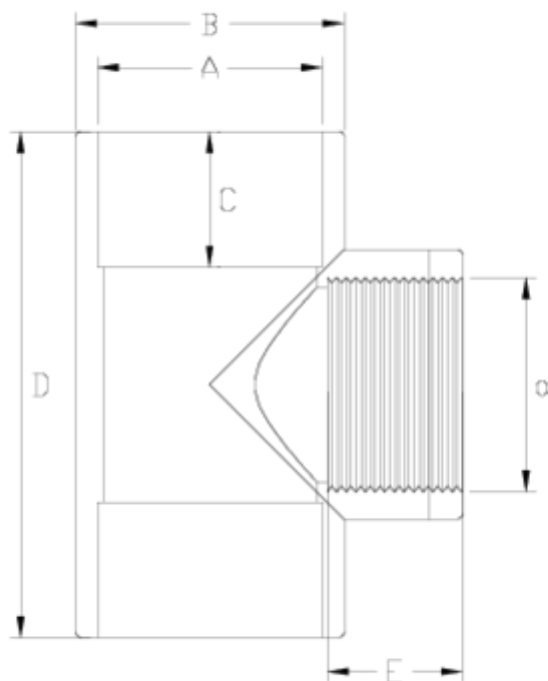

ITEM 436 | Reinforced F/T plain 90° tee

Código	A-a	Peso (g)	B	C	D	E	PN	ROSCA
02180	20-1/2"	34	27	16	56	16	PN10	BSP
02181	25-3/4"	56	33	19	66	17	PN11	BSP
02182	32-1"	96	41	22	79	21	PN12	BSP
02183	40-1 1/4"	165	50	26	95	23	PN13	BSP
02184	50-1 1/2"	218	61	31	114	24	PN14	BSP
02185	63-2"	352	75	38	141	28	PN15	BSP
02186	75-2 1/2"	575	90	45	166	32	PN16	BSP
02187	90-3"	1022	108	51	199	35	PN17	BSP
02188	110-4"	1562	131	61	238	39	PN18	BSP



PRODUCT DOCUMENTS



PRODUCT CERTIFICATES



COMPANY CERTIFICATES

