



## PVC pressure fittings

### Union, plain socket - female thread socket, vsolvent socket outlet - with O-ring ITEM 082



| Ref.    | Description                          | Net W. | Vol. (m <sup>3</sup> ) | Gross W. | Batch |
|---------|--------------------------------------|--------|------------------------|----------|-------|
| 1002084 | ENLACE 3 PZS M/M CON JUNTA 3/4"-25   | 0.076  | 0.00870                | 2.48     | 30    |
| 1002085 | ENLACE 3 PZS M/M CON JUNTA 1"-32     | 0.110  | 0.00892                | 2.83     | 24    |
| 1002086 | ENLACE 3 PZS M/M CON JUNTA 1 1/4"-40 | 0.186  | 0.01553                | 4.79     | 24    |
| 1002087 | ENLACE 3 PZS M/M CON JUNTA 1 1/2"-40 | 0.247  | 0.03682                | 15.41    | 60    |
| 1002088 | ENLACE 3 PZS M/M CON JUNTA 1 1/2"-50 | 0.237  | 0.04717                | 14.86    | 60    |
| 1002089 | ENLACE 3 PZS M/M CON JUNTA 2"-50     | 0.423  | 0.03129                | 10.73    | 24    |
| 1002090 | ENLACE 3 PZS M/M CON JUNTA 2"-63     | 0.403  | 0.03129                | 10.34    | 24    |
| 1002091 | ENLACE 3 PZS M/M CON JUNTA 2 1/2"-75 | 0.674  | 0.04460                | 15.49    | 22    |



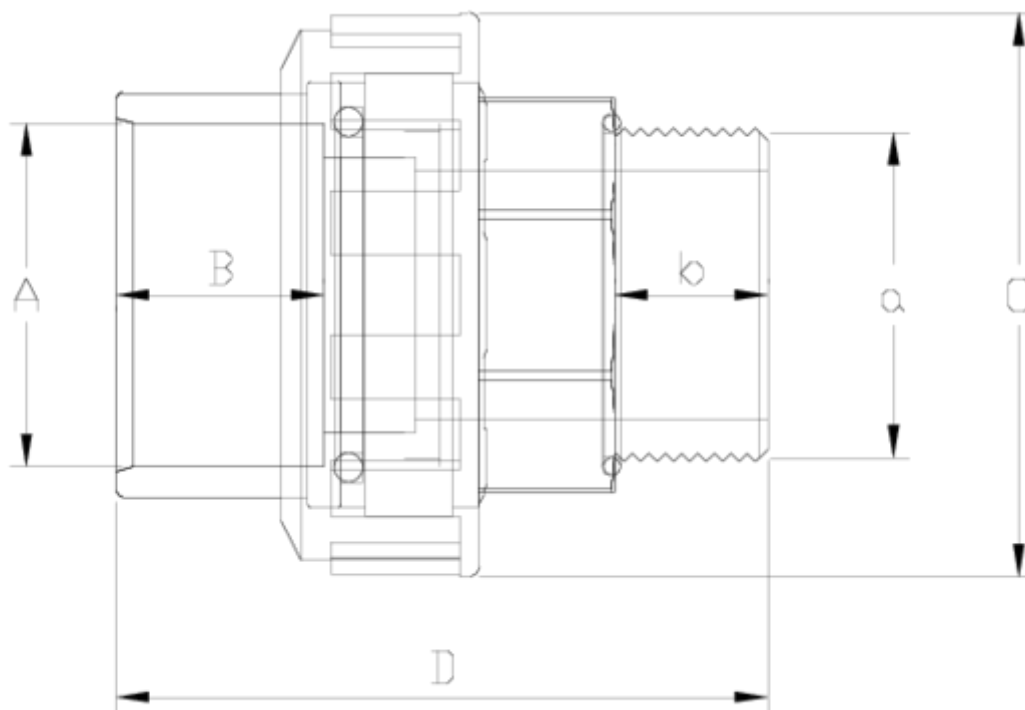

## ITEM 082 | Union, plain socket - female thread socket, vsolvent socket outlet - with O-ring

| Código | a-A         | Peso (g) | B  | b  | C   | D   | PN   | ROSCA |
|--------|-------------|----------|----|----|-----|-----|------|-------|
| 02084  | 3/4" - 25   | 64       | 19 | 16 | 51  | 64  | PN10 | BSP   |
| 02085  | 1" - 32     | 101      | 22 | 19 | 62  | 72  | PN10 | BSP   |
| 02086  | 1 1/4" - 40 | 184      | 26 | 21 | 74  | 89  | PN10 | BSP   |
| 02087  | 1 1/2" - 40 | 244      | 26 | 21 | 80  | 93  | PN10 | BSP   |
| 02088  | 1 1/2" - 50 | 233      | 31 | 21 | 80  | 98  | PN10 | BSP   |
| 02089  | 2" - 50     | 434      | 31 | 26 | 99  | 115 | PN10 | BSP   |
| 02090  | 2" - 63     | 420      | 38 | 26 | 99  | 120 | PN10 | BSP   |
| 02091  | 2 1/2" - 75 | 630      | 44 | 30 | 120 | 135 | PN10 | BSP   |



## PRODUCT DOCUMENTS



## PRODUCT CERTIFICATES



## COMPANY CERTIFICATES

